

TILLAMOOK COUNTY SURVEYORS OFFICE

1/4 corner common to sections 20 and 21 T.3S.,R.10W.,W.M.

1/4
|
20+21
|
1970

I found a 1 1/4" iron rod with a 3" Tillamook County Surveyors brass cap, (see Tillamook County Surveyors rewitness card #627). I set a 10" cast iron monument case around the found iron rod with brass cap, and encased in concrete.

History of found Monument

I found this monument to be as reported on the above said rewitness, and the accessories found and/or set at that time to now be as follows:

Power pole #BE-Y-134 S.81*W. 24.61', Map B-1375 S.86 1/2*W. 24.6', Rewitness book 4 page 106 S.86*30'W. 24.3' to P.K. tack; (Now S.86 1/2*W. 24.57' to a monument spike I set in a scribed triangle. New number on pole is #208501).

Power pole S.12*W. 103.81', Map B-1375 S.15*W. 103.8', Rewitness book 4 page 106 S.15*W. 103.48'; (Now S.15*W. 103.81' to a P.K. tack in a scribed triangle and 103.45' to a nail with shiner in the scribing "1/4S20BT". Pole is number is #208400).

*96" hat section post West 16.75'; (Found OK).

* Indicates yellow Tillamook County corner tag affixed.

Surveys and rewitnesses of reference not listed on card #627:

A-1917	1970	Harold Russell	L.S.707
A-3713	1979	Frederick Gaylord	L.S.929
B-619	1971-72	Richard R. Kelley	P.E.2652
A-4243	1980	Frederick Gaylord	L.S.929
B-1375	1989	Darius K. Ferguson	L.S.2279
Rewitness book 5 page 199		1966 John L. Carlich	R.S.287
Rewitness book 1 page 84		1949 W.E. Anderson	County Surveyor

Monument Location

This corner is located in approximately the centerline of Sandlake County road, 1/2 mile South of Galloway County Road junction and at the junction of a gravel road to the East which goes to a quarry.

In the presence of Dan McNutt & Al Dvorak

October 8, 1990

Title

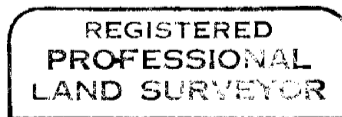

Allan E. Duncan, C.S.

